

Montageanleitung

Ecosteel 30
Schiebetür

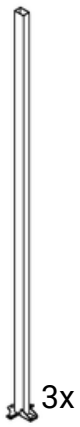

Montage Video



3x

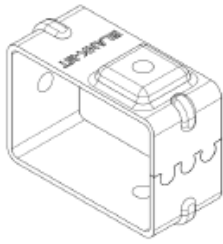

6x



2x

M8x12

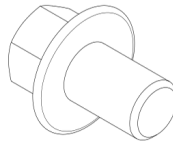

6x

M10x80

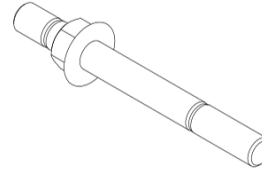

14x

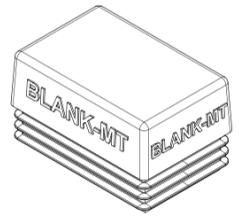

3x

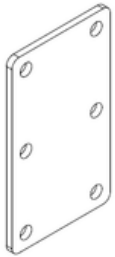

6x

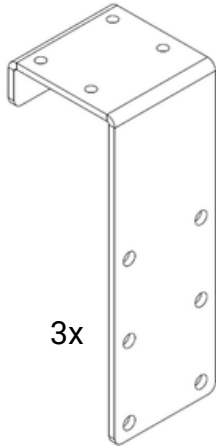

3x

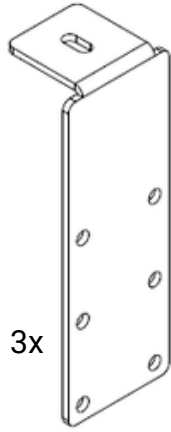

3x

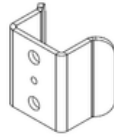

1x

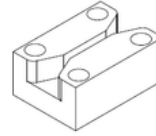

3x

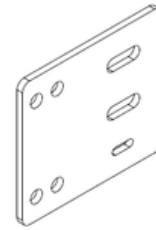

1x

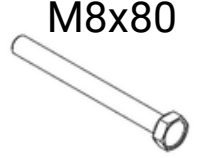

M8x80

24x

M4



1x



1x

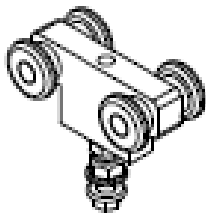

2x



1x



2x

3,5x13



17x

M6x25



12x

M6x16



2x

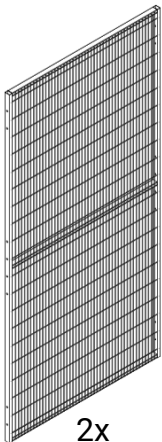

2x

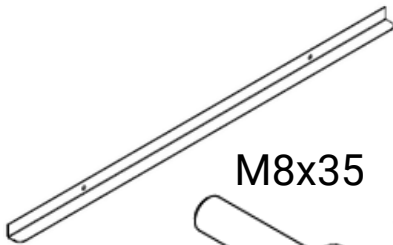

1x

M8x35

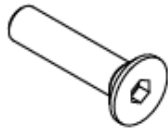

9x

M8x35

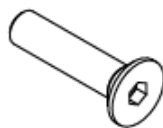

4x

M8x20

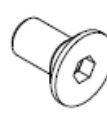

2x

M8



9x

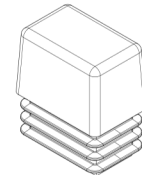

2x

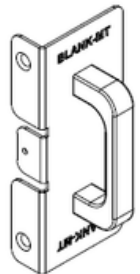

1x

Benötigte
Werkzeuge:



Gabelschlüssel 13mm
Gabelschlüssel 17mm

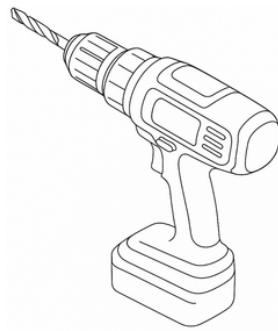

Akkuschrauber mit
Bit-Aufsatz



Schlagbohrmaschine
10mm Bohrer

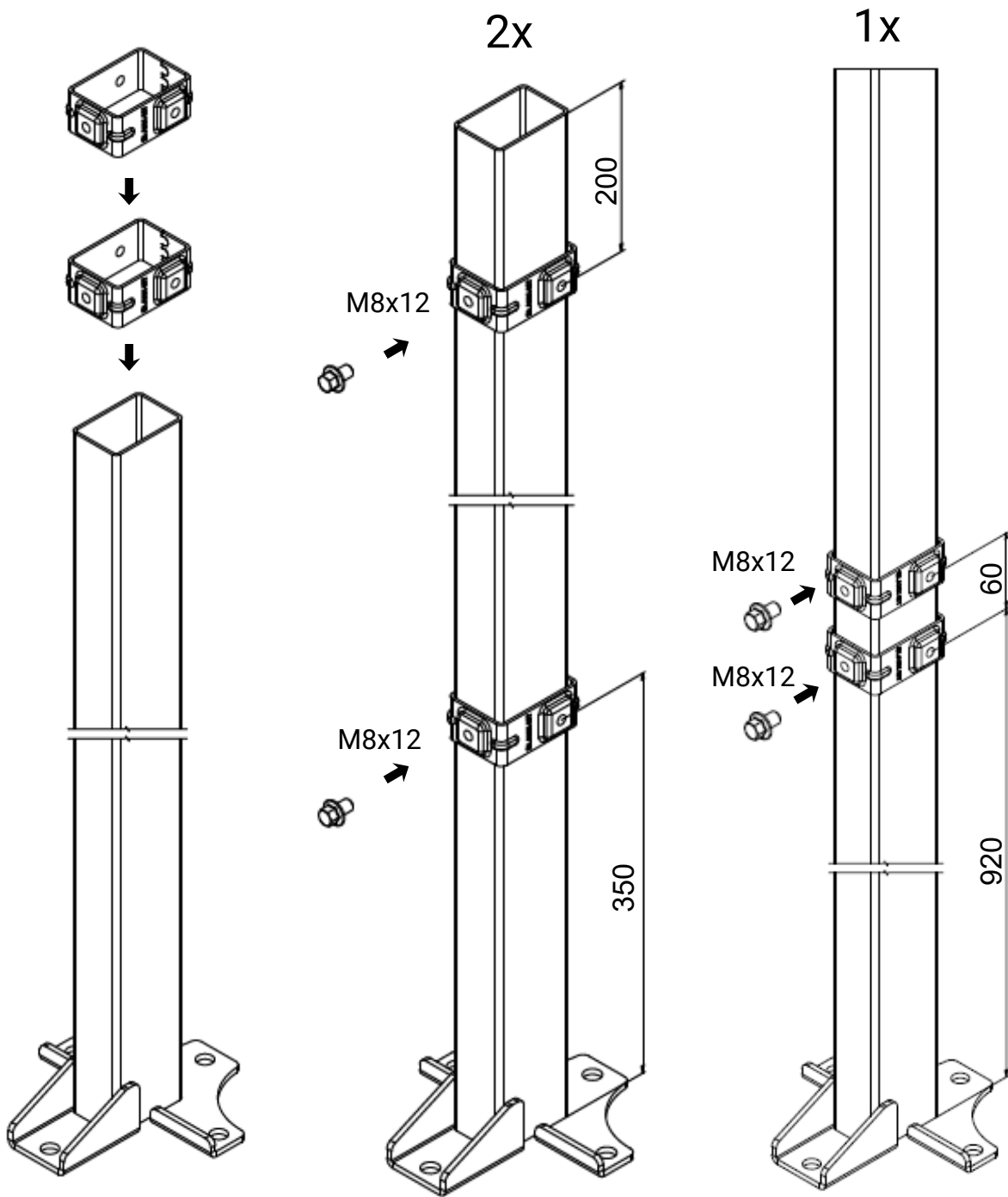

3x

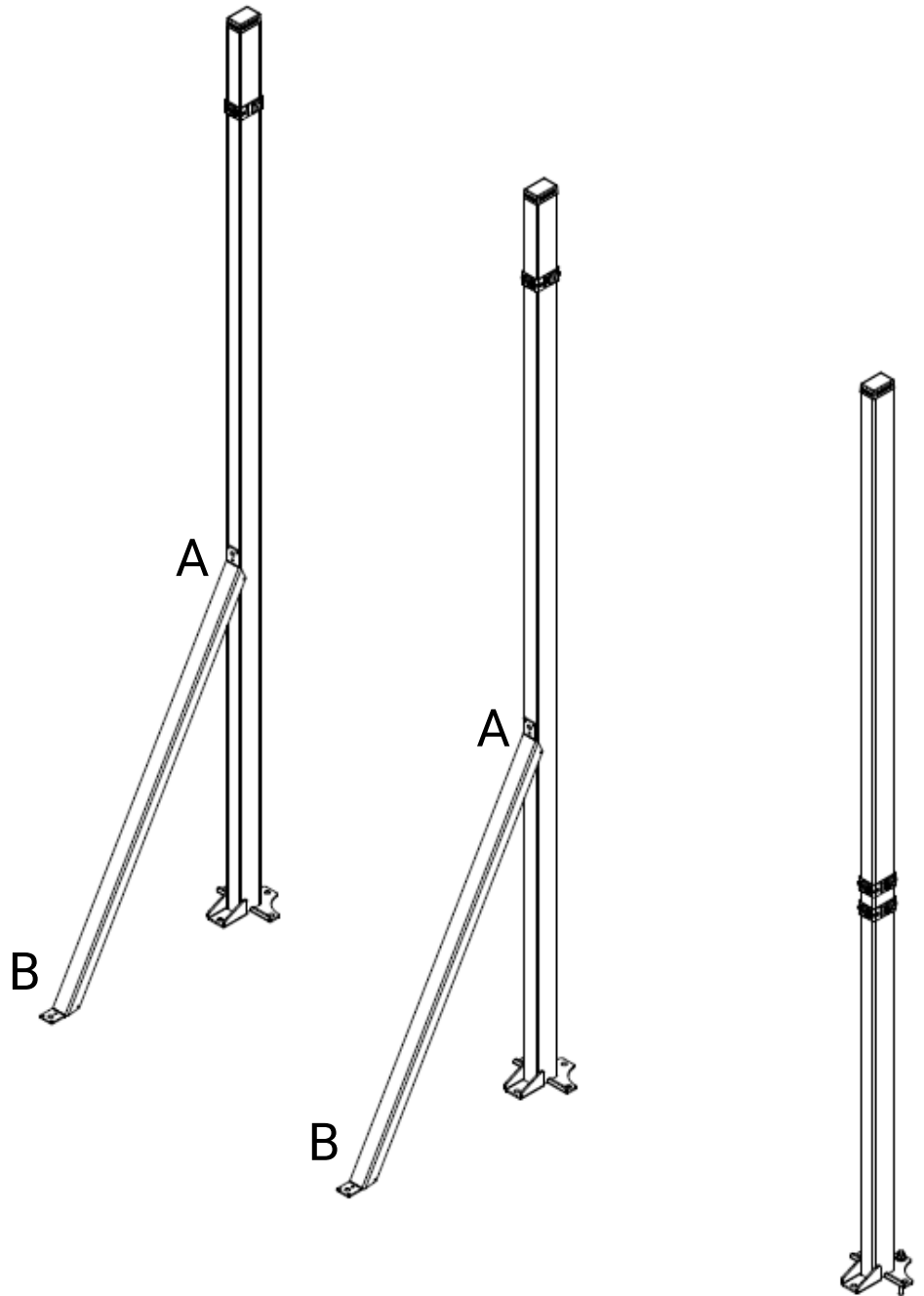
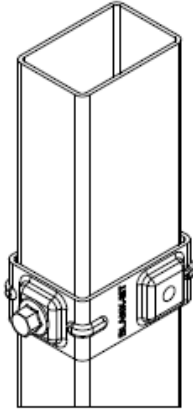

3x

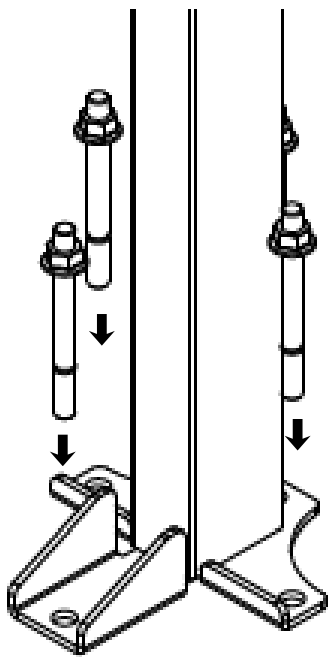

M10x80
(4x)

